

note  
 • the design on this drawing is copyright and remains the property of dhk  
 • all work to be carried out in accordance with the N.B.R. SANS 10400 and applicable industry regulations  
 • the liability of the drawing for construction purposes is not permitted  
 • all dimensions and levels are to be confirmed on site prior to construction  
 • any discrepancies are to be reported to dhk immediately  
 • dhk accepts no responsibility for errors resulting from misinterpretation of this drawing

rev	date	description	name
0	171205	Atrium Ceiling	KS
1	171211	Suspension Hooks added	JW

- CEILING LEGEND:**
- CLG-615 Vogli Acoustic Ceilings
  - CLG-313 Suspended Flush Plasterboard Ceiling
  - CLG-615 Suspended Acoustic Plasterboard Ceiling
  - CLG-316 Suspended Flush Plasterboard Ceiling - Moisture Resistant
  - INS-341 Polycyanurate Insulation Board (PIR), PNT-115 White Emulsion paint
  - PNT-114 Rubbed Down and Painted with White Emulsion Paint To Concrete Soffit
  - CLG-911 Shadowline Cornice
  - Ventilation Slot Detail: DWG: 06-06-006
  - CON-244 Rubbed Down Finish
  - EWM-211 Aluminum composite cladding (Hulabond S18 brushed silver)
  - Exposed Trusses
  - Access Panel
  - Reddeco - Ceiling Type C3 Suspended Vinyl Ceiling
  - Reddeco - Ceiling Type C4 Suspended Laser-cut Timber Ceiling
  - Structural Suspension Hooks

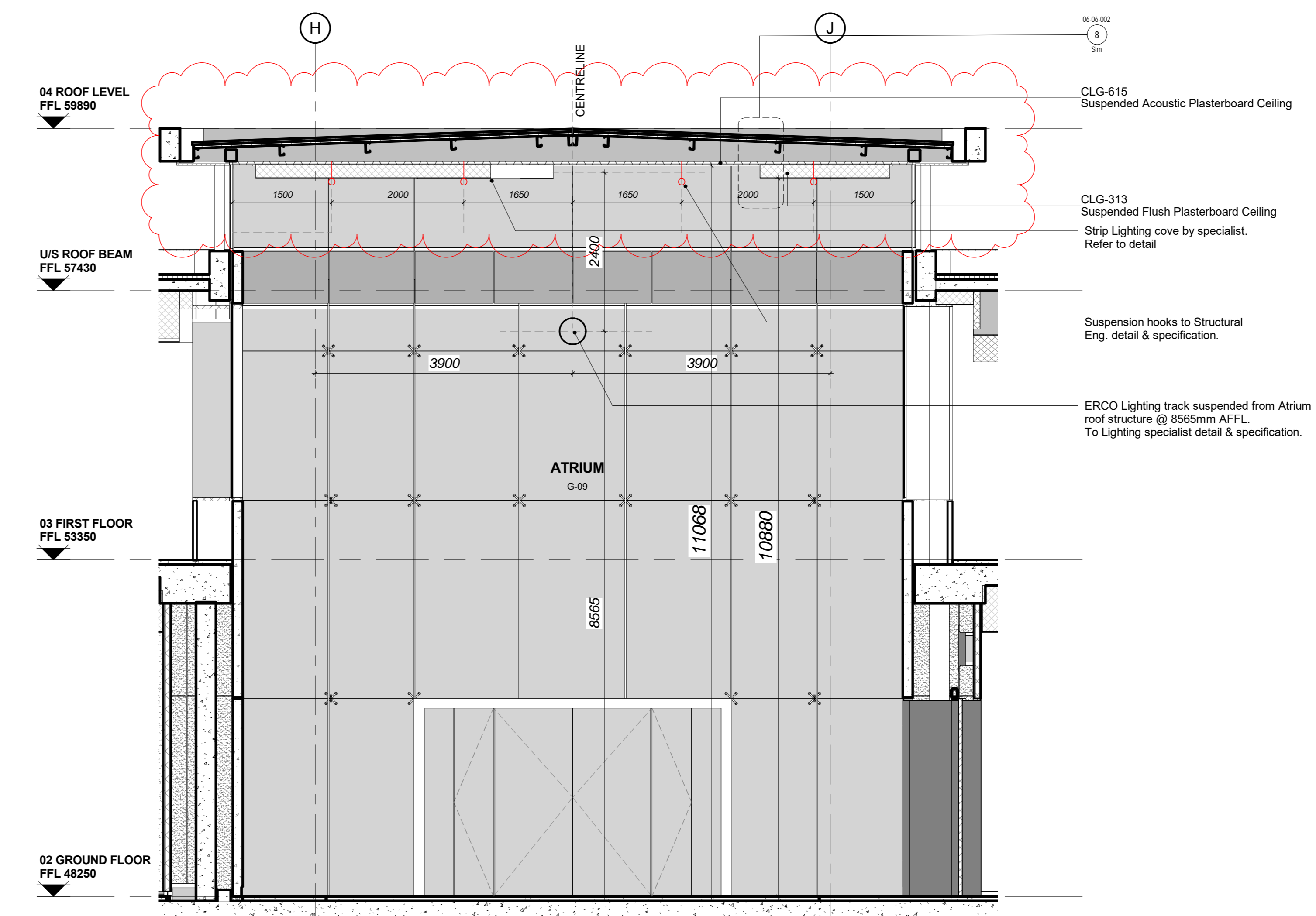

**Atrium Ceiling Section 1**  
 SCALE 1:50

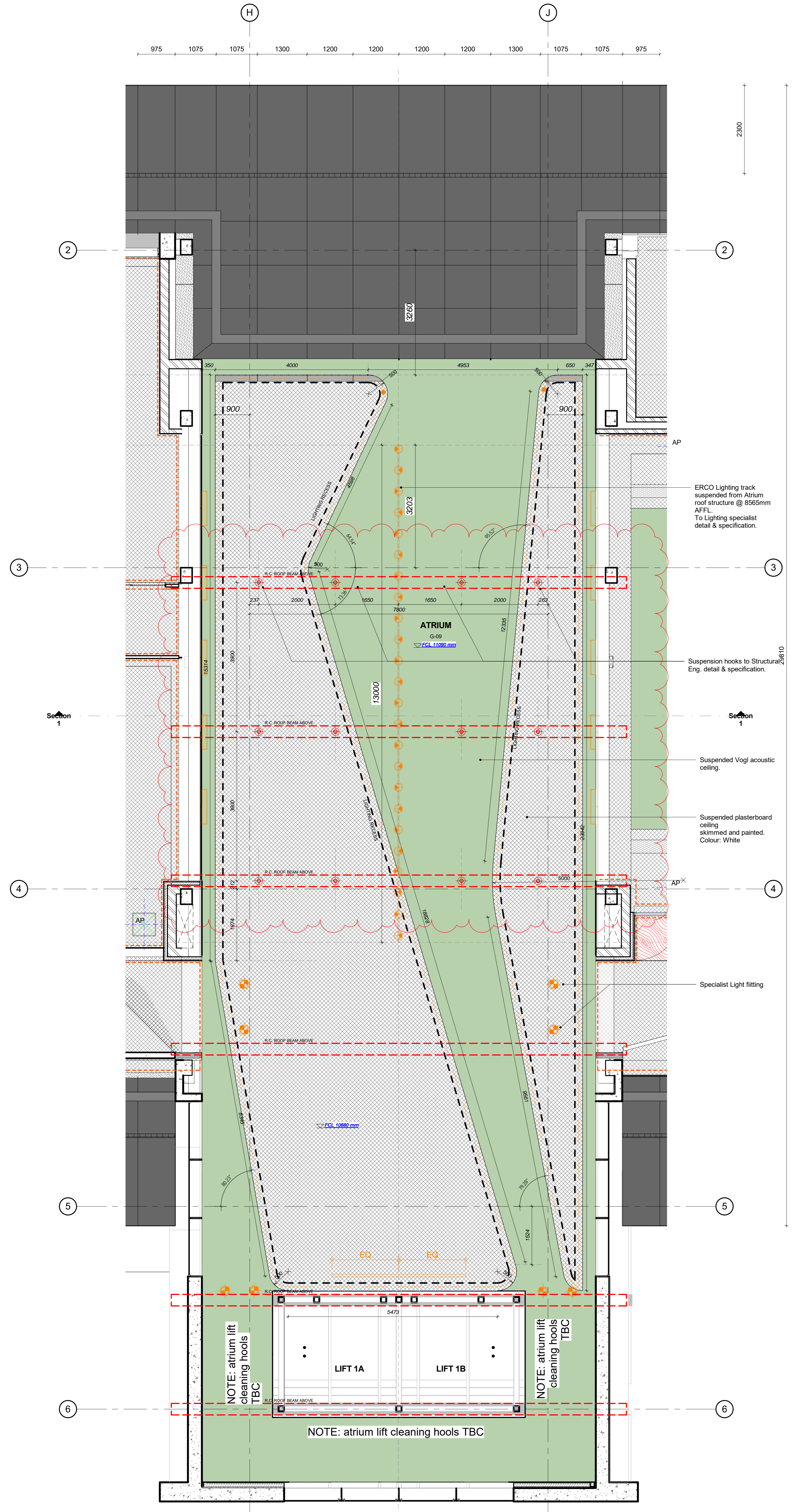

**FIRST FLOOR: Atrium Ceiling Plan**  
 SCALE 1:50

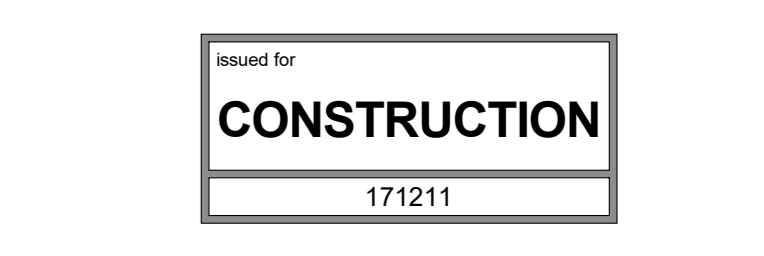

**dhk** architects (Pty) Ltd  
 6th Floor, de waterkant centre  
 9 somerset road, cape town  
 tel: +27 (0) 21 421 6803  
 fax: +27 (0) 21 421 0670  
 email: architects@dhk.co.za  
 reg no: 1998/020807/07

project: **NORVAL FOUNDATION**  
 client: **NORVAL FOUNDATION**  
 drawing:

project number	drawing number	revision
11033	01-24-011	1
11/29/17	As indicated @ A0	