

VENUE PROFILE

NORVAL FOUNDATION





INTRODUCTION

Norval Foundation's event spaces offer unlimited possibilities. It was designed to include adaptive spaces that can be transformed to align the needs of each event. From the very first glimpse of Norval Foundation, set in the heart of the Steenberg wine region, one can sense the ambition of the project. By stepping inside the venue, one understands that you are surrounded by the art that has shaped our world. Africa's history is indelibly intertwined with each space. The Foundation runs the gamut of artistic endeavour, from Irma Stern's Arab, and Cecil Skotnes' Head Study, to Gerard Marx and William Kentridge's Fire Walker, among hundreds of other works. The Norval Foundation is honoured to be the custodians of the Gerard Sekoto Foundation, Edoardo Villa Estate Collection, and the Alexis Preller Archive.

GROUND FLOOR

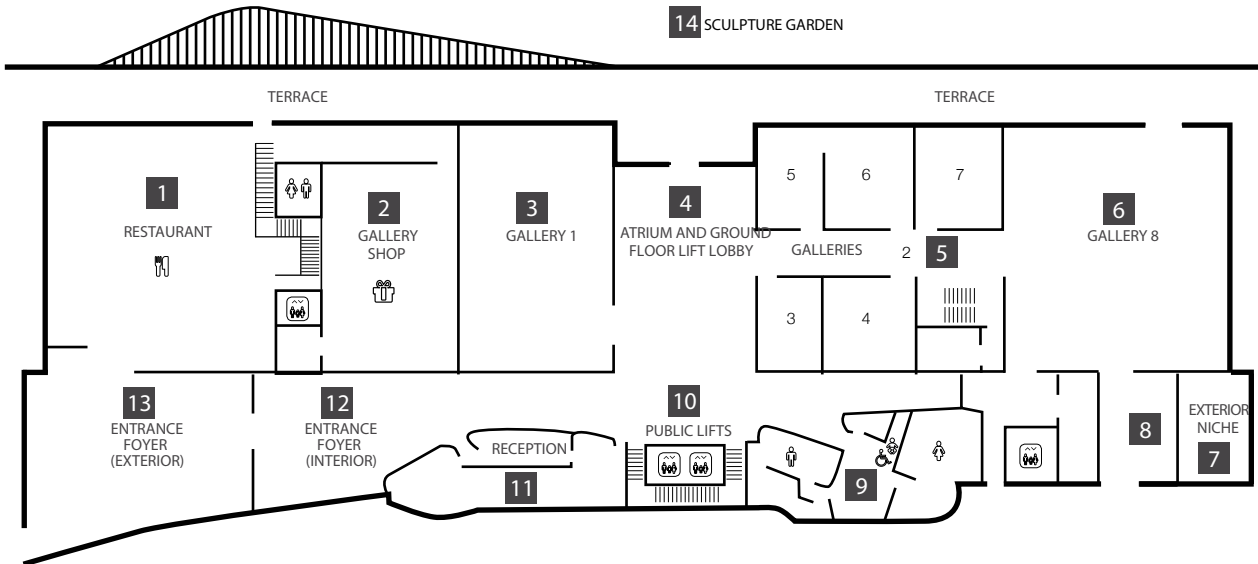

- 1** SKOTNES RESTAURANT & DELI
- 2** GALLERY SHOP
- 3** GALLERY 1
- 4** ATRIUM AND GROUND FLOOR LIFT LOBBY
- 5** GALLERIES 2 – 7
- 6** GALLERY 8
- 7** EXTERIOR NICHE
- 8** SERVICE LIFTS
- 9** WC
- 10** PUBLIC LIFTS
- 11** RECEPTION
- 12** EXTERIOR FOYER (INTERIOR)
- 13** EXTERIOR FOYER (EXTERIOR)
- 14** SCULPTURE GARDEN

FIRST FLOOR

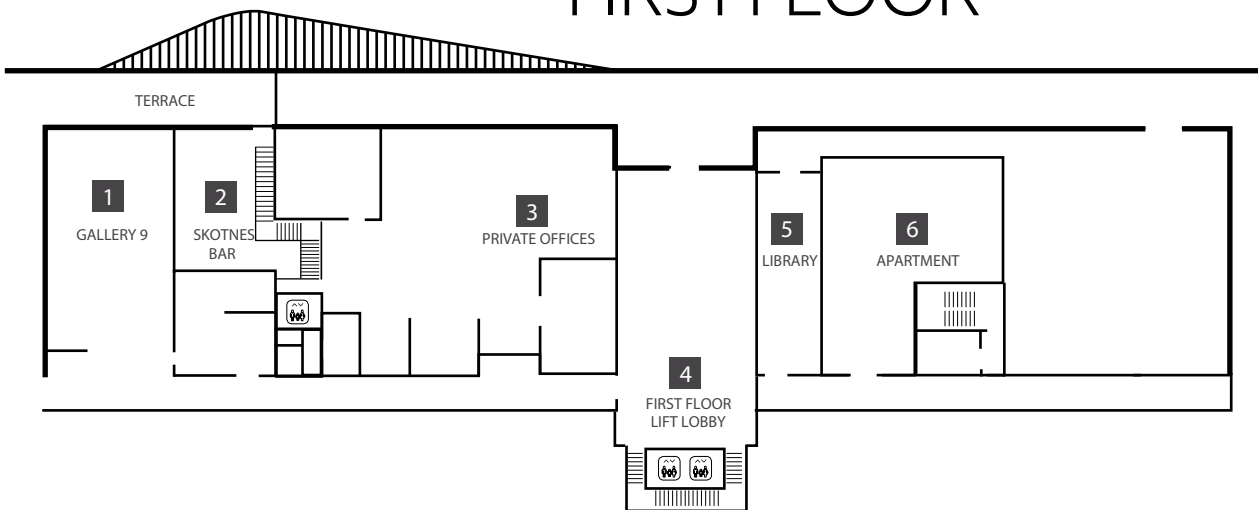

- 1** GALLERY 9
- 2** SKOTNES BAR
- 3** PRIVATE OFFICES
- 4** FIRST FLOOR LIFT LOBBY
- 5** LIBRARY
- 6** APARTMENT

-  LIFT
-  WC
-  FAMILY ROOM
-  RESTAURANT
-  GALLERY SHOP



THE SKOTNES RESTAURANT

THE SKOTNES VENUE (INCLUDES THE DECK)

Overlooking the Foundation's serene wetland and innovative sculpture garden, The Skotnes Restaurant seamlessly integrates nature and architecture. It is the perfect venue for foodie events and can be utilised for formal or informal gatherings where the focus is on delectable cuisine. Please note that The Skotnes Restaurant is available for exclusive use corporate and private events.

TRADING HOURS: Monday – Saturday 08h00 – 17h30
 Sunday 08h00 – 16h30
 Tuesday Closed



THE SKOTNES BAR

THE SKOTNES BAR VENUE

The Skotnes Bar was designed with relaxation in mind and is stocked with the Cape's finest wines and a range of spirits and brews from all corners of the globe. The use of The Skotnes Bar is included in the venue rental fee for Gallery 9.

The Skotnes Bar can only be hired as a stand-alone venue if no events are booked for Gallery 9.

Please contact events@norvalfoundation.org for more information.



GALLERY 1

GALLERY 1 VENUE (INCLUDES THE ATRIUM)

An open, welcoming space adjacent to Norval Foundation's Atrium, Gallery 1 could easily transport you to any of the most modern gallery spaces the world has to offer. Clean lines dominate the enclosed, private venue, offering a sophisticated and flexible space for the most discerning of planners.

Please contact events@norvalfoundation.org for more information.



GALLERY 2-7

GALLERY 2 - 7 VENUE (INCLUDES GROUND LEVEL FOYER)

This group of interleading small galleries are adaptable to the needs of the exhibition or event. They offer an ideal setting for intimate dinners or pre-dinner drinks. The art that adorns these walls add the visual component to what is already a feast for the senses.

Please contact events@norvalfoundation.org for more information.



GALLERY 8

GALLERY 8 VENUE

A contemporary, light-filled gallery with views of the Steenberg Valley and Table Mountain, Gallery 8 is bound only by one's imagination. Talks, launches and bespoke gatherings can be held in Gallery 8, to add to the Foundation's selection of event venues.

Please contact events@norvalfoundation.org for more information.



ATRIUM & LIFT LOBBY

ATRIUM VENUE

An elegant, triple-volume space that is designed to inspire awe. A unique installation will move into the space each year – the current installation is by Kapwani Kiwanga: *Shady*. Keynote addresses and welcoming drinks can be held in this space, as well as networking sessions as the space is designed to facilitate the movement of people.

Please contact events@norvalfoundation.org for more information.



GALLERY 9

GALLERY 9 VENUE (INCLUDES FIRST FLOOR LOBBY & BAR)

Situated above The Skotnes Restaurant, Gallery 9 is a modernist space with spectacular views of Steenberg and Tokai. It is a vibrant venue that serves as a focal point for the energy of the building. Exhibitions, events, networking and presentations are best served by this space, and guests are sure to be wowed by the sublime views and cutting-edge design elements.

Please contact events@norvalfoundation.org for more information.



SCULPTURE GARDEN & AMPHITHEATRE

SCULPTURE GARDEN VENUE

Norval Foundation's Art Museum and Sculpture Garden occupy a site that is of environmental and ecological importance. This sensitive wetland site had over many years deteriorated into a wasteland of invader species of plants. The development of this site has brought about renewal and regeneration of the wetland by removing all alien and invasive plant species. These areas have been sensitively replanted by Keith Kirsten International, with indigenous flora that is local to the area. The adjoining seven residential platforms will be landscaped using the same principles.

Please contact events@norvalfoundation.org for more information.



THE LIBRARY

THE LIBRARY VENUE

Libraries are inherently places of quiet and contemplation, and the hand-tooled bookcases and fittings that encompass the library at Norval Foundation add to the spirit of intellection. Art aficionados are sure to be swept away by a comprehensive collection of digital and printed books, on the subjects of art, culture, history, and more. The Library can also be used for small meetings of the C-suite, or high-calibre decision-making.

Please contact events@norvalfoundation.org for more information.



STILLS & FILM SHOOTS

STILLS SHOOTS

Maximum of 25 pax - 10 hour shoot day - R 30 000 ex vat.

FILM SHOOTS

Maximum of 60 pax - 12 hour shoot day - R 60 000 ex vat.

Please note that additional staff, security and cleaning costs may apply based on the shoot brief. Above rates are based on shooting on a Tuesday when we are closed to the public.

Please send detailed shoot brief to nina@nvdproperty.co.za.

CONTACT

Should you wish to make a booking or have any questions – please do not hesitate to get in touch.

NINA VAN DEVENTER

events@norvalfoundation.org

+27 76 336 2130

AAYESHA PARKER

info@nvdproperty.co.za

+27 60 997 7977

MALIZE JACOBS

malize.jacobs@norvalfoundation.org

+27 82 803 0736

VISIT OUR WEBSITE:

www.norvalfoundation.org

www.nvdproperty.co.za/properties-2/228-Norval-Foundation/

Please include the following information or complete the online event enquiry form here - <http://nvdproperty.co.za/contact/>

Date:

Time:

Agenda – flow of event:

Number of pax / guest:

Setup - cocktail / seated / conference / launch:

Catering brief:

Budget guideline:

SITE INSPECTIONS & RECCES:

Please note that site inspections and recces are by appointment only.